

# Electric Pedestrian Stacker 1200KG

## DS3-12

Distinguishing mark	1.1	Manufacturer			EP
	1.2	Model designation			DS3
	1.3	Drive			Electric
	1.4	Operator type			Pedestrian
	1.5	Load capacity	Q	kg	1200
	1.6	Load center distance	c	mm	600
	1.8	Load distance, centre of drive axle to fork	x	mm	802
	1.9	Wheelbase	y	mm	1210
	Service weight	2.1	Service weight		kg
2.2		Axle loading, laden front/rear		kg	750/1270
2.3		Axle loading, unladen front/rear		kg	375/145
Tyres/chassis	3.1	Tyre type			Polyurethane
	3.2	Tyre size, front			Ø190×55
	3.3	Tyre size, rear			Ø74×88
	3.4	Additional wheels (castor wheels)		mm	Ø128×50
	3.5	Wheels, number front/rear (x=drive wheels)		mm	1x, 1/2
	3.6.1	Tread width, front	b <sub>10</sub>	mm	597
	3.7.1	Tread width, rear	b <sub>11</sub>	mm	420
Dimensions	4.0	Max. Lift Height	H	mm	3018
	4.2	Retracted mast height	h <sub>1</sub>	mm	2067
	4.4	Lift height	h <sub>3</sub>	mm	2930
	4.5	Height, mast extended	h <sub>4</sub>	mm	3532
	4.9	Height of tiller handle in drive position min./max.	h <sub>14</sub>	mm	760/1140
	4.15	Lowered height	h <sub>13</sub>	mm	90
	4.19	Overall length	l <sub>1</sub>	mm	1727
	4.20	Length to face of forks	l <sub>2</sub>	mm	577
	4.21	Overall width	b <sub>1</sub> /b <sub>2</sub>	mm	834
	4.22	Fork dimensions	s×e×l	mm	75/170/1150
	4.24	Fork carriage width	b <sub>3</sub>	mm	680
	4.25	Fork spread	b <sub>5</sub>	mm	570
	4.32	Ground clearance, center of wheelbase	m <sub>2</sub>	mm	30
	4.34.1	Aisle width for pallets 1000×1200 crossways	Ast	mm	2286
	4.34.2	Aisle width for pallets 800×1200 lengthways	Ast	mm	2219
4.35	Turning radius	Wa	mm	1455	
Performance data	5.1	Travel speed, laden/unladen		km/h	4.0/4.5
	5.2	Lifting speed, laden/unladen		m/s	0.085/0.13
	5.3	Lowering speed, laden/unladen		m/s	0.105/0.085
	5.8	Max. gradeability, laden/unladen		%	3/10
	5.10	Service brake			Electromagnetic
Electric-engine	6.1	Drive motor rating S2 60 min		kW	0.75
	6.2	Lift motor rating at S3 15%		kW	2.2
	6.4	Battery voltage/nominal capacity		V/Ah	24/80
	6.5	Battery weight		kg	38
Drive/lift mechanism	8.1	Type of drive control			DC
Addition data	10.5	Steering design			Mechanical
	10.7	Sound pressure level at the driver's ear		dB(A)	74
	15.1	Charger output current		A	10

If there are improvements of technical parameters or configurations, no further notice will be given.  
The diagram shown may contain non-standard configurations.

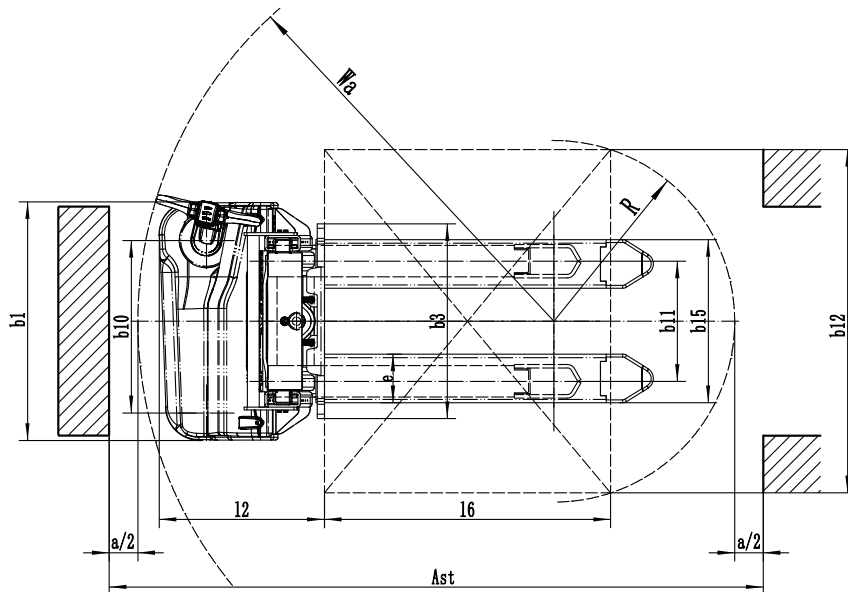
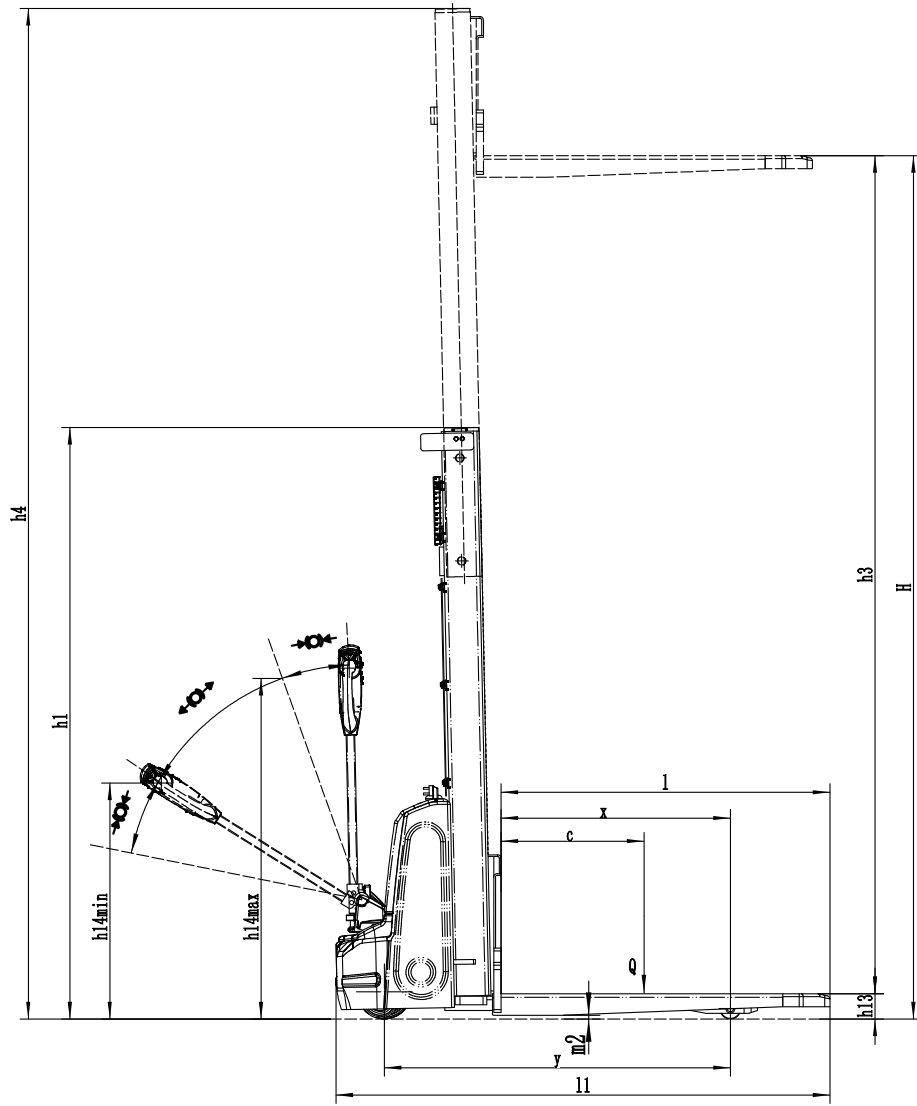

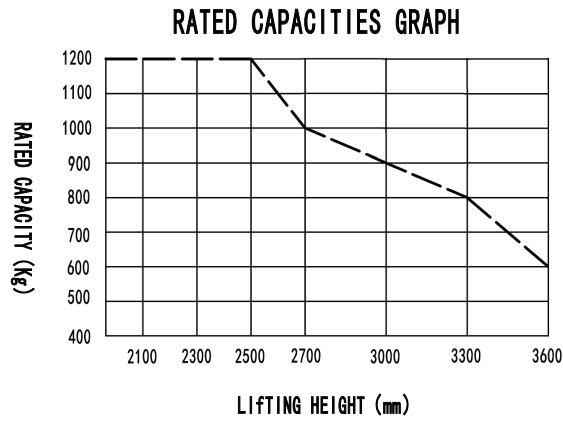

## Mast Option

### C Channel Beam

Mast types	Lift height h3+h13	Height, mast lowered h1	Free lift h2	Height, mast extended h4
	mm	mm	mm	mm
2-Standard Mast	2518	1817	—	3032
	2718	1917	—	3232
	3018	2067	—	3532
	3318	2217	—	3832
	3618	2367	—	4132
	3918	2517	—	4432

## Option

Optionele items	DS3
Fork dimension	<ul style="list-style-type: none"> <li>●570*1150○685*1150</li> <li>○570*1000○685*1000</li> <li>○570*1220○685*1220</li> </ul>
Fork lowered height	●90
Fork carriage width	●680mm○795mm
Load wheel type	●Single
Load wheel material	●Polyurethane
Drive wheel material	●Polyurethane
Battery capacity	<ul style="list-style-type: none"> <li>●80Ah (Lead acid)</li> <li>○40Ah (Li-ion)</li> </ul>
Charger	<ul style="list-style-type: none"> <li>●24V-10A internal (Lead acid)</li> <li>○24V-15A internal (Li-ion)</li> </ul>
Battery indicator	●Without hourmeter
Tiller head type	<ul style="list-style-type: none"> <li>●Double-grip big tiller head</li> <li>○EP large tiller head(with finger controls including turtle button)</li> </ul>
Castor wheels	●Yes and not customized
Vertical tiller creep speed	●Yes and not customized
Speed reduction with elevated mast	●Yes and not customized
Note:	●Standard ○ Optional - Inconformity